



Side screen

markilux 790

Ideal, lateral protection against low-lying sun, light wind and inquisitive glances.

Product properties



face fixture bracket for the front profile with angle for lateral fixture ¹⁾



docking post with welded-on base plate



sleeve assembly for insertion in the ground



safety mechanism for the handle fitted to the docking post

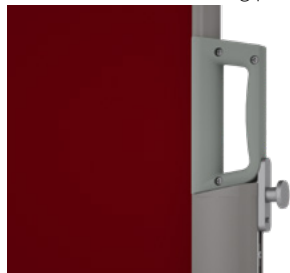

mobilfix: docking post fitted to a granite baseplate ¹⁾



docking bracket for front profile fitted to a railing



docking bracket for front profile fitted to a free-standing post or markilux pergola / pergola compact



detail at the top: pivoting option to fit the cassette to a free-standing markilux pergola / pergola compact post ¹⁾



detail at the bottom: pivoting option to fit the cassette to free-standing markilux pergola / pergola compact post ¹⁾



¹⁾ optional configuration

Product properties

Description

- the discretely shaped side screen giving allround protection to the cover thanks to the satisfactory, square cassette.

Special features

- the height of the grip on the front profile can be adjusted to the exact conditions on site – so that the front profile can be locked in position and the cover tension adjusted without a problem
- the pre-set tension in the spring mechanism can be adjusted on site to comply with the wishes of the customer
- The screen cover can be cut diagonally to order, in which case the front profile will be correspondingly shorter – giving perfect protection in combination with a markilux folding-arm awning or markilux pergola / pergola compact
- intermediate screen heights and a good choice of fixture options are available – to make them employable on a patio, a balcony or even free standing
- docking post for the front profile with integrated safety lock for the grip to prevent it being released inadvertently

Dimensions

- awning in the standard version 173 cm / 213 cm / 250 cm in height
- extension: 200–450 cm (depending on the screen height and fabric pattern)
- intermediate sizes are available

Roller tube and lateral bearings

- round roller tube Ø 63 mm with keyway, galvanised steel, with integrated, maintenance-free spring mechanism providing optimum cover tension
- the roller tube bearing is made of machine finished, rolled aluminium

Awning profiles

- Extruded aluminium, in façade quality, powder coated
- cassette profile in one piece, 95 mm × 95 mm
- circular front profile Ø 32 mm

Side caps

- end caps are made of high-quality plastic, dyed through or powder coated – at the spring end they are aluminium, powder coated
- the front profile end caps are made of high-quality plastic, dyed through in grey

Fixture brackets

- cassette brackets for face or reveal fixture, fixture to a post (free standing or to the post of the markilux pergola / pergola compact / markilux syncra)
- brackets for the front profile: face fixture, docking post with ground sleeve / base plate for bolting down, mobilfix (mobile docking post on a base plate), brackets for fixture to a (balcony) railing
- grip for front profile made of high-quality plastic, dyed through in grey
- adapter sets for fixture to Krinner screw-in foundations

Frame colours

markilux awning colours without surcharge

traffic white RAL 9016



metallic aluminium RAL 9006

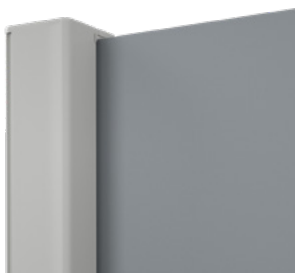

grey brown, similar to RAL 8019



off-white textured finish, 5233 ¹⁾



stone grey metallic, 5215 ¹⁾

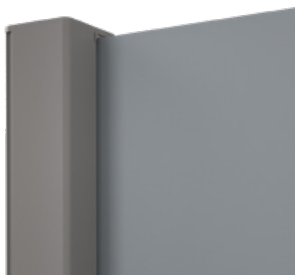

anthracite metallic, 5204 ¹⁾



Havana brown textured finish, 5229 ¹⁾

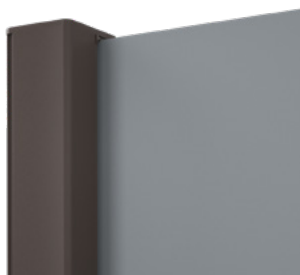

16

17

Non-standard powder-coated finish

Bespoke frame colours at a surcharge – matt, metallic and pearl finishes as well as other colour ranges (DB, Tiger etc.) on request. All frame colours are available at a surcharge with enhanced corrosion protection.

¹⁾ textured finish

Colours may differ slightly from those depicted in both hue and finish.

Dimensions and configuration options

Single unit

| | | Extension | | | | |
|------------------|-------------------|-----------------|-----------------|-----------------|-----------------|-------------------|
| | | 250 | 300 | 350 | 400 | 450 ¹⁾ |
| Order dimensions | | 200 — 250 | 251 — 300 | 301 — 350 | 351 — 400 | 401 — 450 |
| | | | | | | |
| GH | 173 ²⁾ | | | | | |
| | 213 | | | | | — |
| | 250 | | | | | — |

dimensions in cm

1) = angled top edge not possible

2) = minimum height 90 cm

GH = overall height (cassette height + 30 mm)
intermediate sizes are available at surcharge

| | |
|--|-------------------------------|
| | = cover height approx. 162 cm |
| | = cover height approx. 202 cm |
| | = cover height approx. 239 cm |

| Operation | standard | optional |
|-------------------------|----------|----------|
| manual extension | ✓ | — |
| cover exit to the right | ✓ | — |
| cover exit to the left | — | ✓ |

| Awning cover | fabric range no. | standard | optional | overall height | extension | tailored cloth |
|-------------------|-------------------------------|----------|----------|----------------|-------------|----------------|
| sunvas | 301.. / 309..–315.. | ✓ | — | | | SN |
| sunsilk | 324.. / 325.. / 328.. / 369.. | ✓ | — | | | SN |
| transolair | 338.. | — | ✓ | | ≤ 240 | N |
| | | | | | > 241 | SN |
| vuscreen Alu | 317.. | — | ✓ | ≤ 213 | ≤ 240 | N |
| | | | | ≤ 213 | ≥ 241 ≤ 300 | SN |
| perfortex | 331.. / 332.. | — | — | | | |
| perla | 370.. | — | — | | | |
| perla FR | 374.. / 375.. | — | — | | | |
| Soltis Perform 92 | 92–20.. | — | — | | | |

dimensions in cm

N = Seamless

SN = vertical seam, panel width 120 cm

| | | | |
|--|--------|--|--------|
| Fixture brackets | | Fixture brackets | |
| face fixture bracket 50 mm | 78758. | cassette bracket for reveal fixture 50 mm | 77845. |
| wall docking option | 77822. | angled bracket for lateral face fixture 175 × 60 × 60 mm | 77987. |
| docking bracket for front profile with clamp for fixture to a railing Ø 40–45 mm | 77984. | free-standing post 1730 mm–1830 mm Ø 70 mm with footplate for cassette fixture | 71175. |
| docking bracket for front profile with clamp for fixture to a railing Ø 45–50 mm | 77985. | brackets for fixture of the cassette to the markilux pergola / pergola compact | 71174. |
| docking post with welded footplate 950 mm | 77820. | bracket for fixture of the front profile to a post Ø 70 mm | 71136. |
| docking post with ground sleeve 950 mm | 77821. | brackets for fixture of the cassette to a square post of the markilux syncra | 72231. |
| | | brackets for fixture of the cassette to a round post of the markilux syncra | 72208. |
| | | mobilfix granite including docking post | 778211 |
| | | mobilfix concrete including docking post | 76838. |
| | | adapter set for post fixture to a Krinner screw-in foundation ¹⁾ | |
| | | adapter set for front profile fixture to a Krinner screw-in foundation ¹⁾ | |

Dimension overview, cover with diagonally cut top edge

Please give the dimensions indicated when ordering

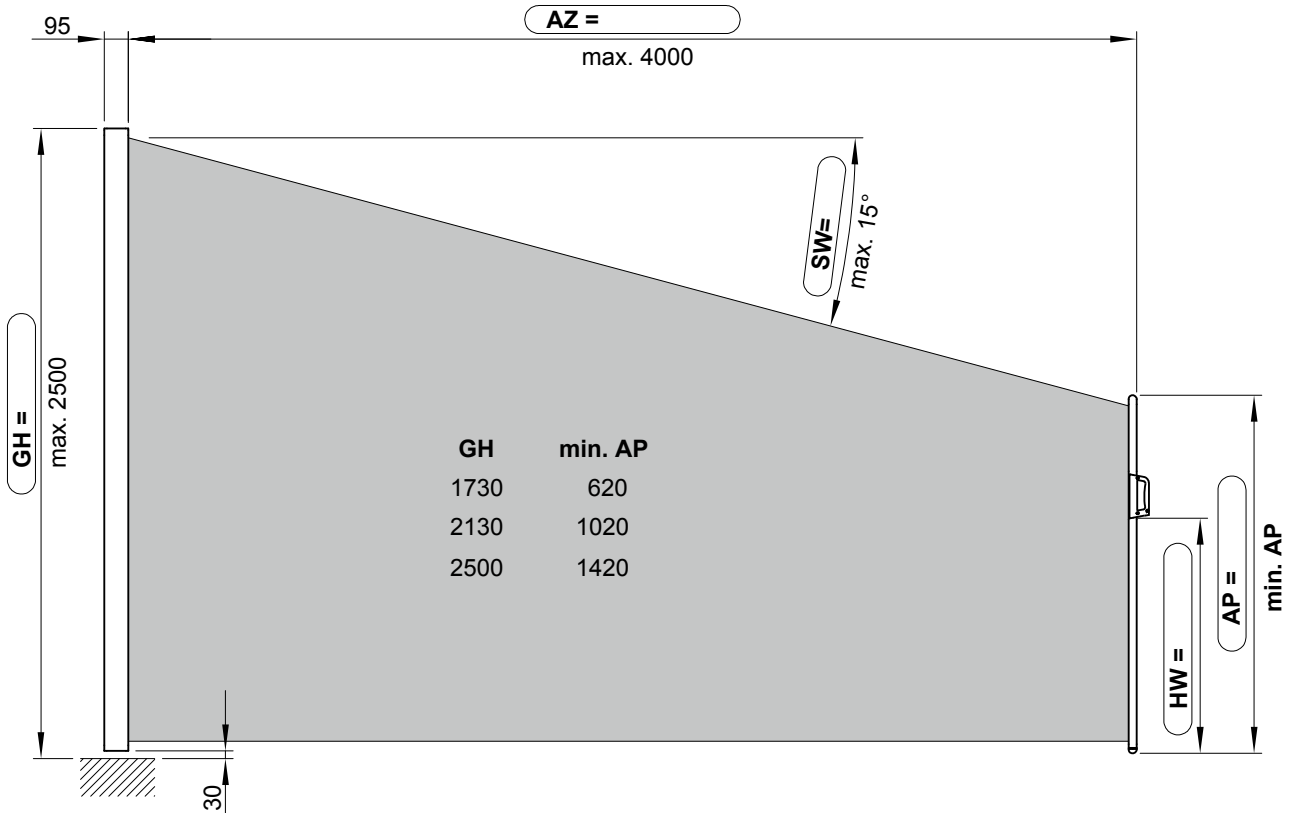

- 1)

= for a detailed description see the separate markilux sales documentation “Krinner – the screw-in foundation”
- AP

= height of the front profile
- AZ

= order measurement = extension
- GH

= order measurement = overall height side screen
- HW

= height of the wall docking bracket
- SW

= angle of the top edge of the cover
- dimensions in mm

Dimension overview, standard cover

Docking post with welded bottom plate, ground sleeve or face fixture bracket

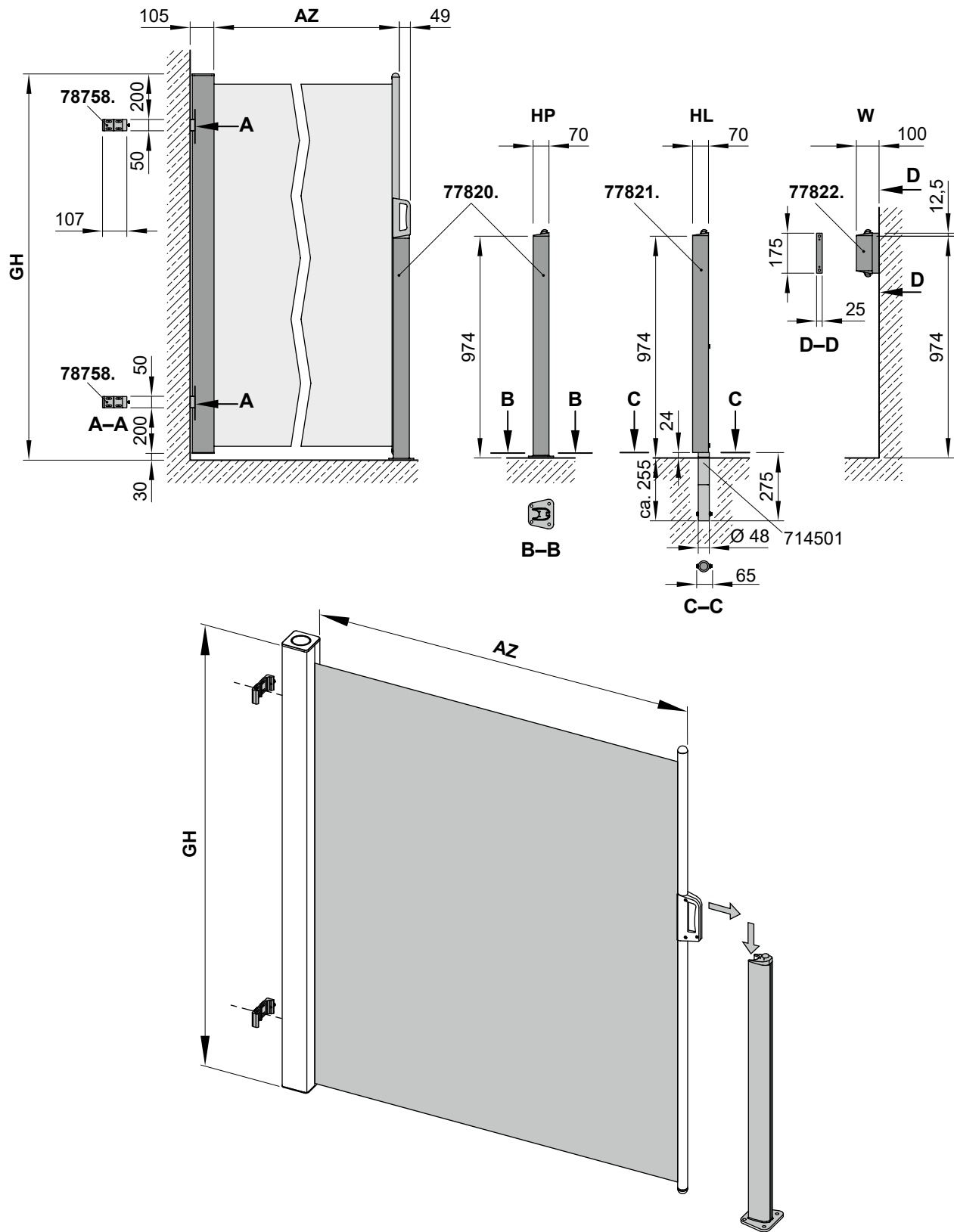

- AZ = order measurement = extension
- GH = order measurement = overall height side screen
- HL = sleeve assembly for insertion in the ground
- HP = docking post for fixture to solid surface
- W = face fixture

dimensions in mm

Face fixture, face fixture bracket for the cassette

Fixtures, fittings and accessories

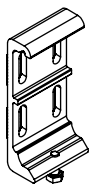

Face fixture bracket
50 mm

78758.

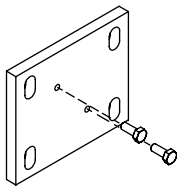

spreader plate
120 × 100 × 10 mm

78982.

Cover exit to the right standard (see figure) – cover exit to the left optional

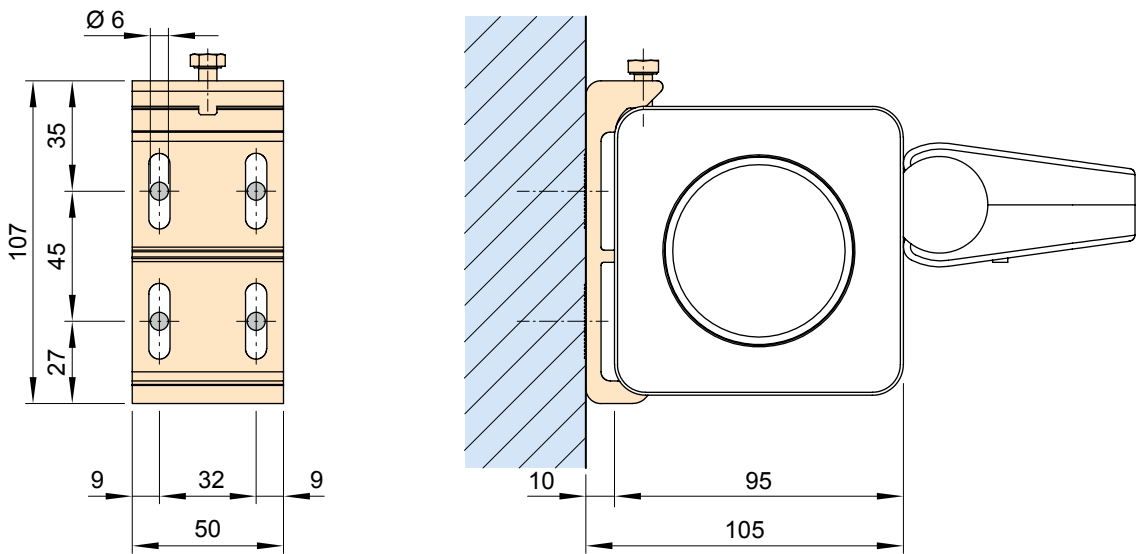

16

Spreader plate for universal bracket assembly

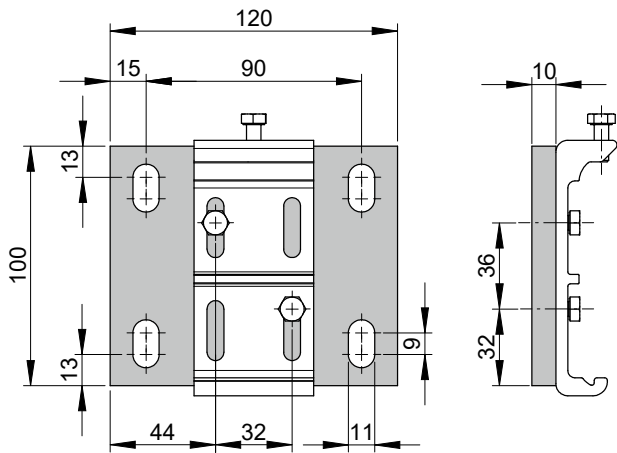

dimensions in mm

Face fixture, face fixture bracket for the cassette

Fixtures, fittings and accessories

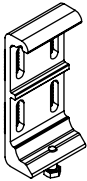

Face fixture bracket
50 mm

78758.

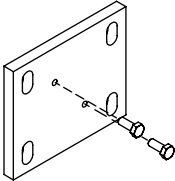

spreaders plate
120 × 100 × 10 mm

78982.

Cross section view with face fixture bracket for the front profile

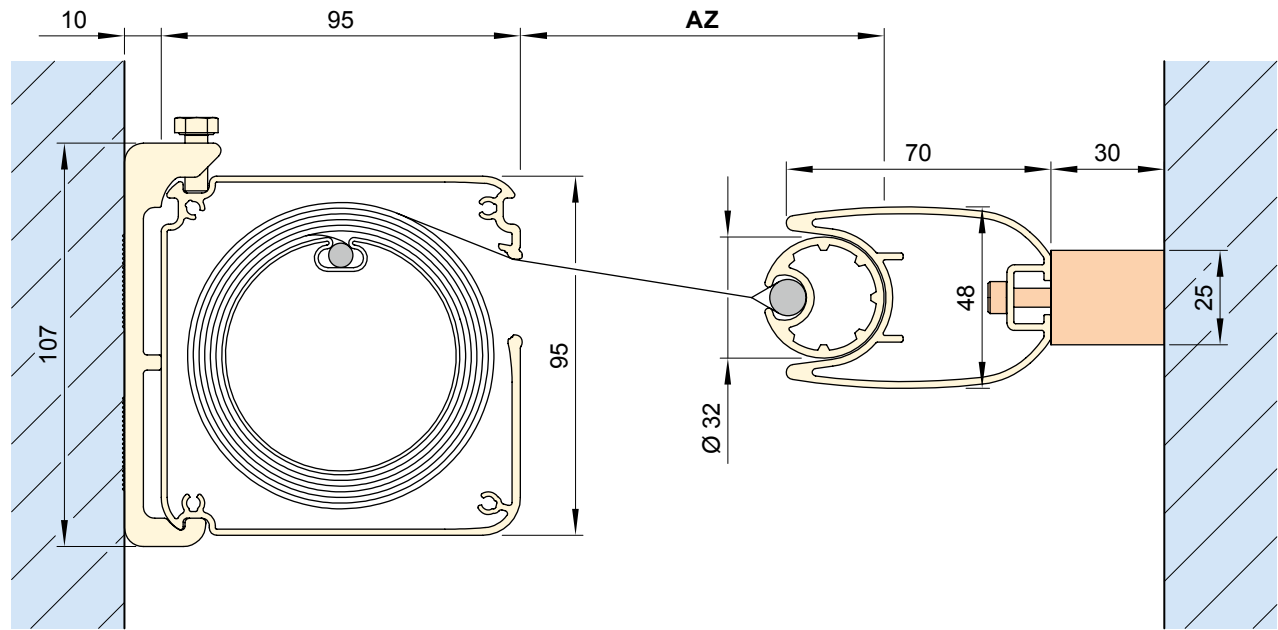

Face fixture, face fixture bracket for the front profile

Fixtures, fittings and accessories

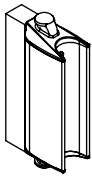

Face fixture bracket for the front profile

77822.

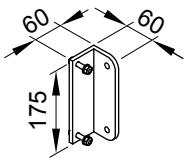

face fixture bracket assembly for the front profile 77822.

175 × 60 × 60 mm

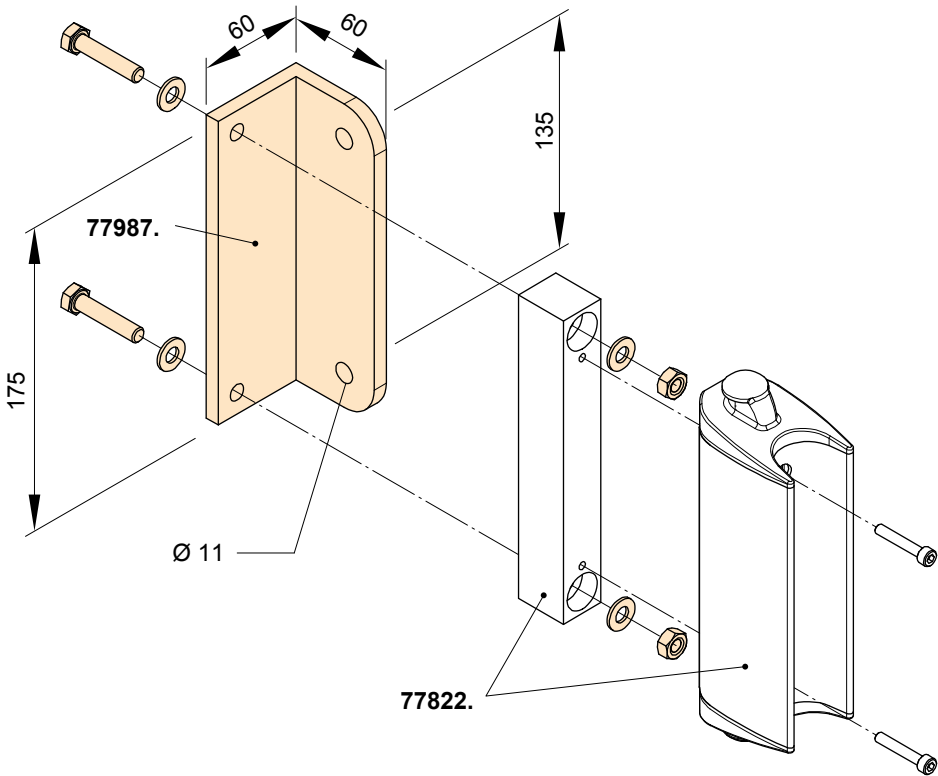
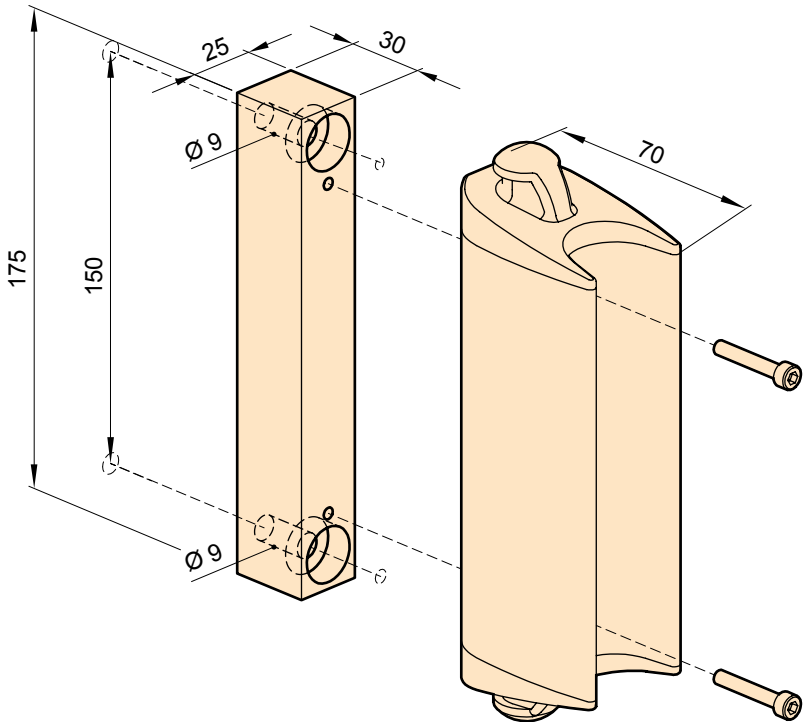

77987.



dimensions in mm

Docking post for front profile

Fixtures, fittings and accessories

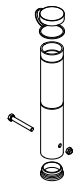
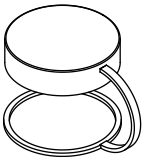
| | | |
|---|--|--|
|  <p>docking post assembly for the front profile with welded base plate</p> <p>77820.</p> |  <p>docking post assembly (for the front profile) for the ground sleeve</p> <p>77821.</p> |  <p>ground sleeve</p> <p>714501</p> |
|  <p>covering cap for ground sleeve</p> <p>702851</p> | | |

With a footplate for fixture to a solid surface (77820.)

With connecting profile and ground sleeve (77821.)

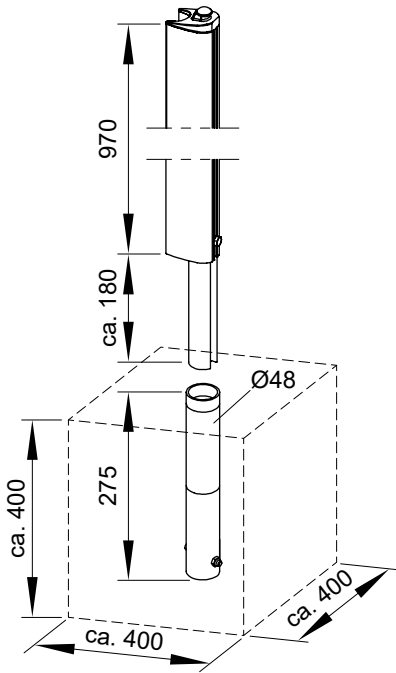
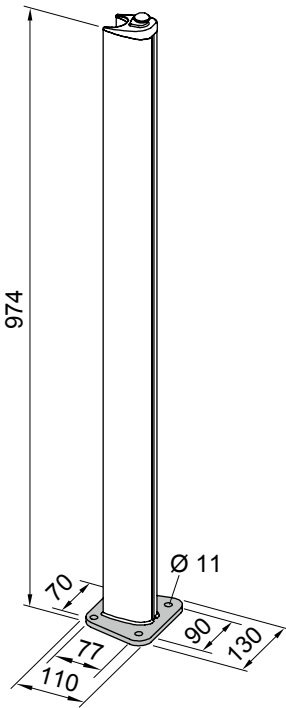

dimensions in mm

mobifix

Fixtures, fittings and accessories

| | | |
|---|---|---|
|  <p>mobifix: docking post mounted on a granite base plate 1) approx. 40 kg</p> <p>77821. 778941 778931</p> |  <p>Additional granite slab for the mobilfix (recommended in light wind) approx. 39 kg</p> <p>779311</p> |  <p>mobifix 2: docking post mounted on a concrete base plate approx. 55 kg</p> <p>76838.</p> |
|---|---|---|

Granite is a natural stone and can vary in colour and structure.

Note: The markilux mobilfix is only to be used up to a maximum screen height of (GH) 213 cm.

mobifix

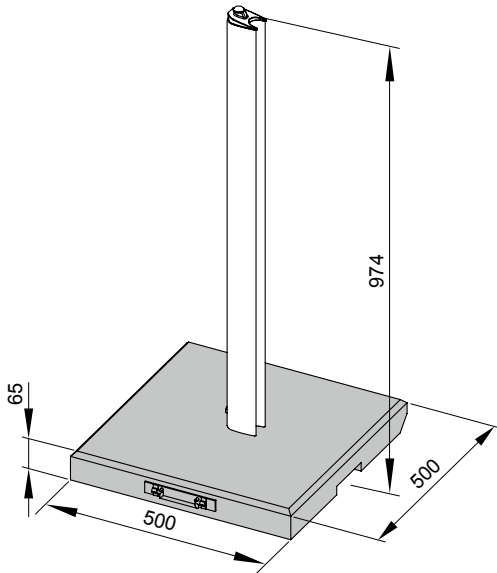

mobilefix with additional granite slab to weigh it down

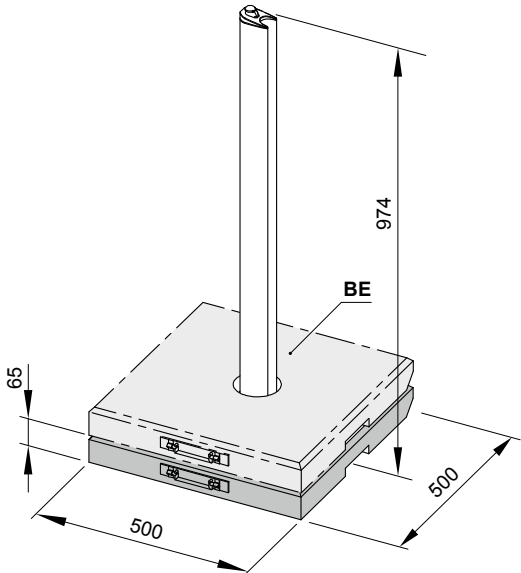

mobifix 2

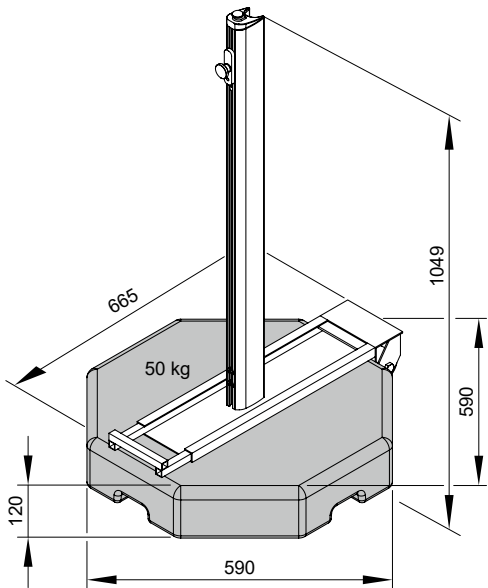

transport function mobilfix 2

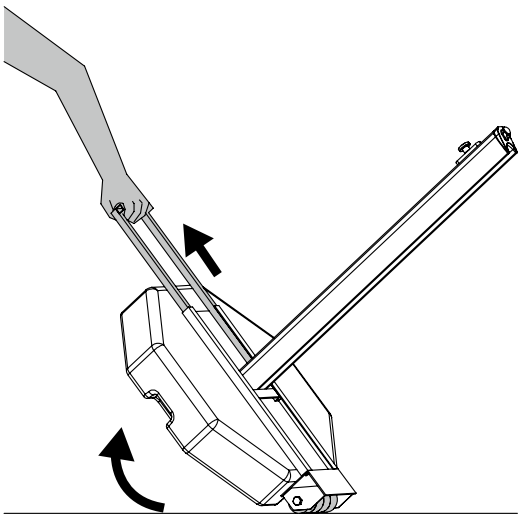

BE = additional granite slab to weigh it down (optional)

dimensions in mm

Railing bracket assembly for front profile

Fixtures, fittings and accessories

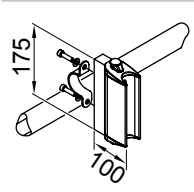

railing bracket assembly
Ø 40-45 mm

77984.

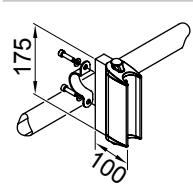

railing bracket assembly
Ø 45-50 mm

77985.

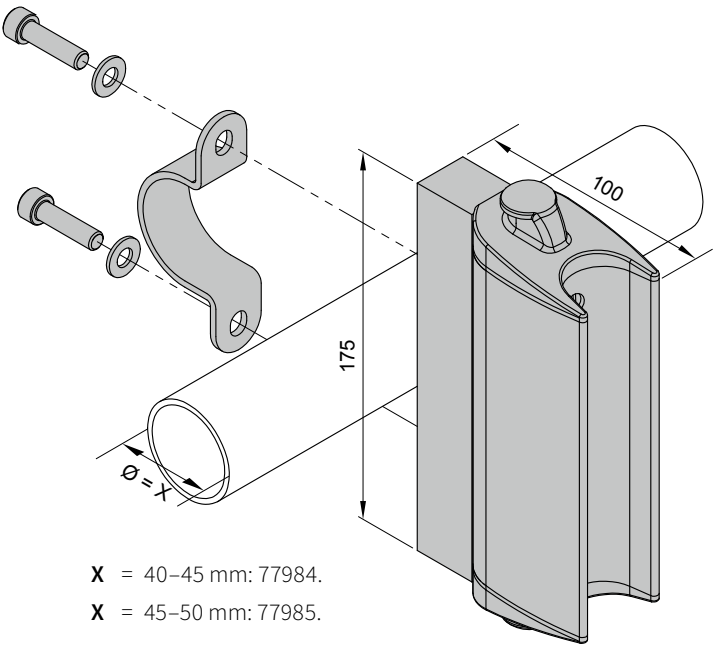

dimensions in mm

Front profile fixture to a post

Fixtures, fittings and accessories

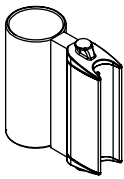

face fixture bracket
for the front profile
for markilux pergola /
pergola compact round

71136.

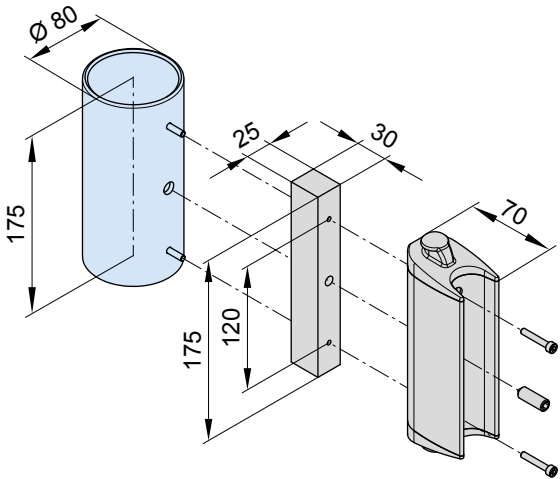

Fixtures, fittings and accessories

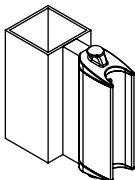

face fixture bracket
for the front profile
for markilux pergola /
pergola compact square

75279.

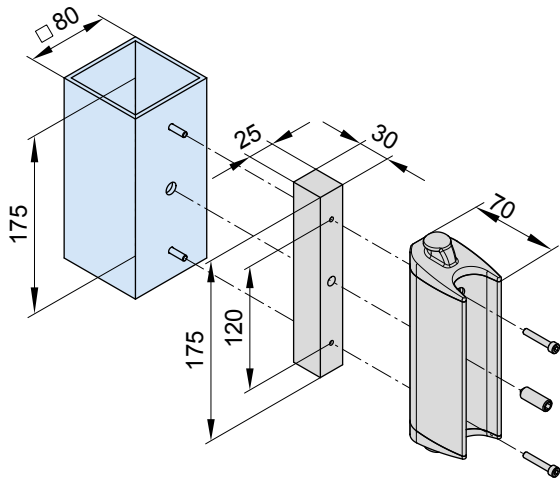

dimensions in mm

Cassette fixture to a post

Fixtures, fittings and accessories



post with base plate

overall height adjustable
from approx. 1730 mm
to 1830 mm, Ø 70 mm

71172.



universal fixture bracket:
for cassette fixture to
the post of the markilux
pergola / pergola
compact, 2 pieces

height approx. 80 mm
Ø 70 mm

71174.

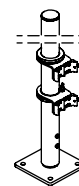

post 71172 including
base plate 71174.; fixture
assembly for universal
bracket for cassette
overall height adjustable

overall height adjustable
approx. 1730–1830 mm,
Ø 70 mm

71175.

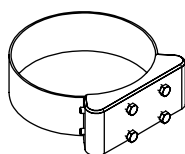

fixture assembly for
universal fixture bracket
78758. to the post of
the markilux syncra 2

width 52 mm, for
post fixture
Ø 140 mm, round post

72208.

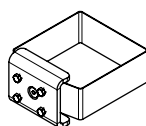

fixture assembly for
universal fixture bracket
78758. to the post of
the markilux syncra

width 52 mm, for
square post
125 × 125 mm

72231.

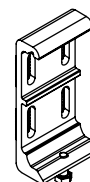

face fixture bracket

50 mm

78758.

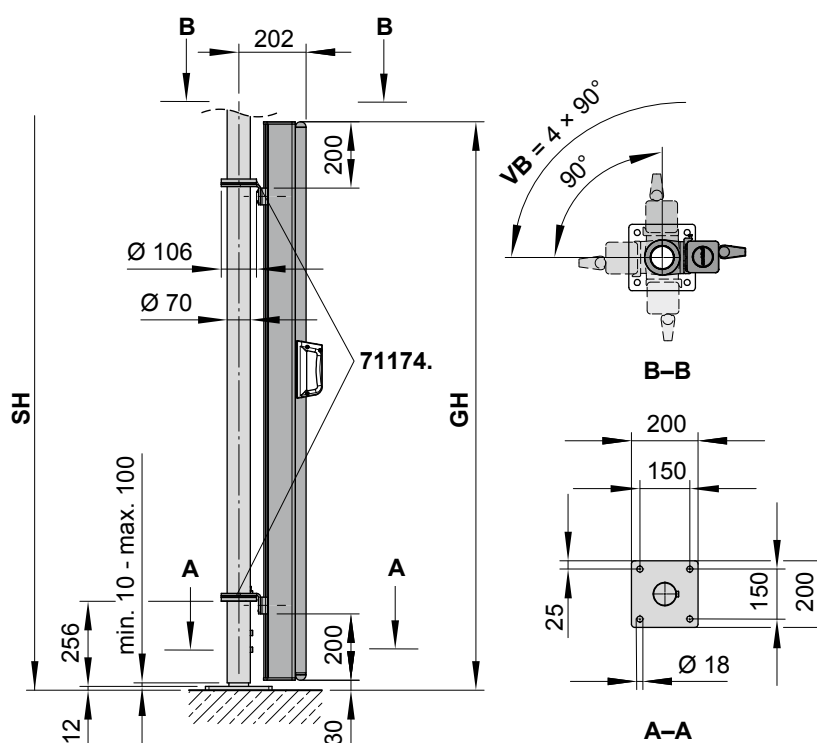

GH = order extension = overall height

SH = support post height

VB = adjustment range (VB) of the fixture brackets with locking lever ($4 \times 90^\circ$)

dimensions in mm

Reveal fixture of the cassette

Fixtures, fittings and accessories

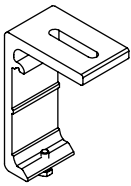

reveal fixture bracket
assembly
50 mm

77845.

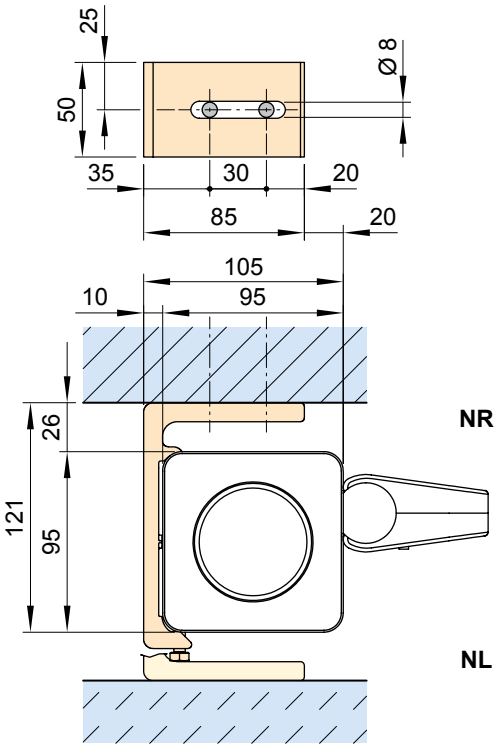

NR = reveal fixture right
NL = reveal fixture left

dimensions in mm